

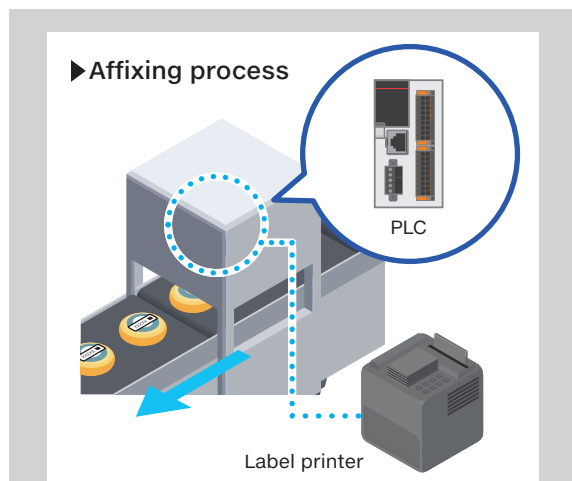

No complicated settings required. Easier connection to devices by using FB.

Challenges with a certain food packaging equipment



System configuration example (Label printer)



Connecting the PLC and the printer is difficult because the settings are complicated. Developing the print process program from scratch takes a lot of man-hours.

Using partner-linked FB eliminates the need for complicated settings and greatly reduces development man-hours.

Solution

By introducing FB

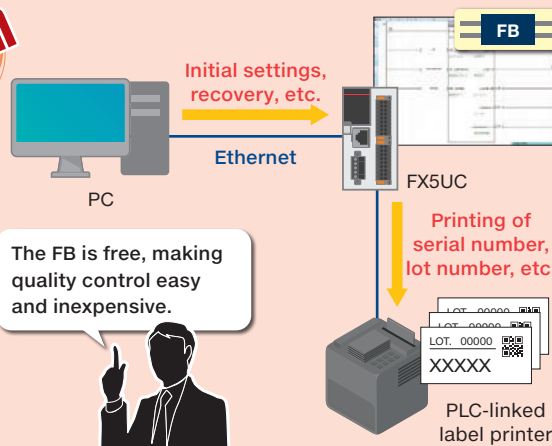

- ✓ The FB has been developed by the connection device manufacturer, making the settings specific to the connection device.
- ✓ Combining the FB with the user's original program provides print control that is synchronized with the production line.

Collaboration with various partner manufacturers



Applicable products	Manufacturer's name	Name
Alignment sensor	Cognex K.K.	AlignSight Connection Function Block and sample project
Vibration sensor (AE sensor)	Schaeffler Japan Co., Ltd.	Communication and Connection Function Block for Vibration Diagnosis Devices
Actuator	IAI Corporation	Predefined Protocol Support for Positioning Function Block
	SMC Corporation	ROBO Cylinder Function Block
	ORIENTAL MOTOR CO., LTD.	Predefined Protocol Support for Positioning Function Block
Laser marker NEW	Videojet X-Rite K.K.	Ultimate Protocol-compatible Laser Marker Function Block
Displacement sensor	OPTEx FA CO., LTD.	Sample project for communication and connection with laser displacement sensors
		Sample project for IO-Link Master
IO-Link	Balluff Co., Ltd.	FB library for CC-Link IE Field Network Basic connection IO-Link gateway



Introduction of the latest linked product from a partner (laser marker)

Laser markers from VIDEOJET, which has a global presence. A device that projects laser light onto the target surface and perform non-contact printing. Since the wavelength of the light can be selected according to the material, it can be used on a wide variety of materials such as metals, plastics, glass, etc. In collaboration with this partner, we offer an FB library for performing marking control of a laser marker connected via Ethernet and MELSEC iQ-F Series PLC.



Laser marker (VJ7810)

Point 1 FB makes introduction to existing lines easy.

► System configuration example

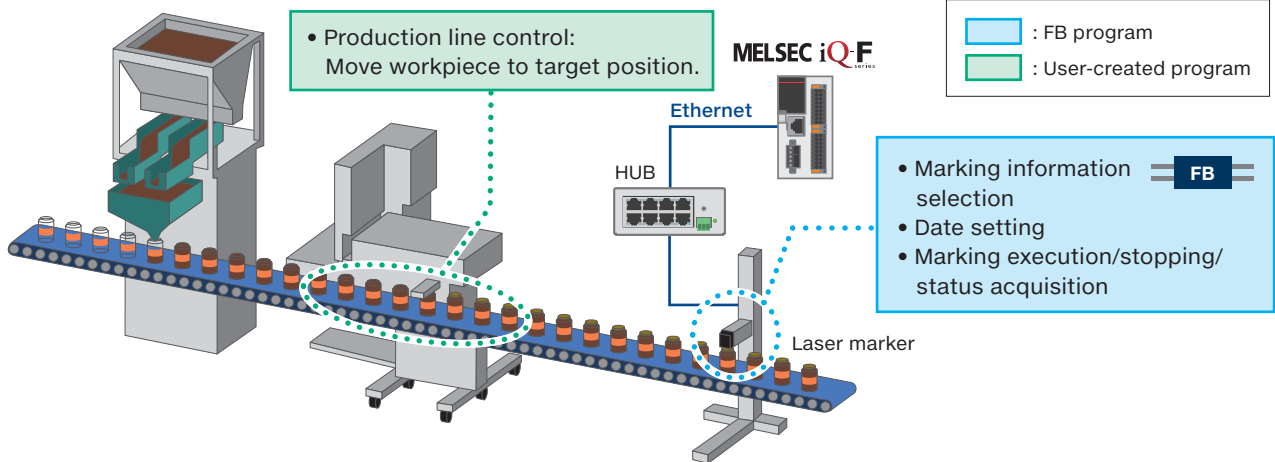

*It is necessary to perform settings for marking in advance using dedicated software.

Point 2 Simple and easy settings using the Sample Screens.

Operations such as "Get Job information" and "Start Marking" etc. on the laser marker can be operated from the GOT screen.



Sample screen example

Benefit 1 Greatly reduced deployment costs

- Sample screens are prepared in advance, so there is no need to create GOT screens.
- Man-hours for deployment are greatly reduced.

Benefit 2 Easy on-site settings

- Settings can be changed with GOT screen operations.
- Printing information such as date, position can be easily edited on-site.

MITSUBISHI ELECTRIC CORPORATION

Please contact your nearest Mitsubishi Electric representative for more information.

⚠ Safety Warning

To ensure proper use of the products in this document, please be sure to read the instruction manual prior to use.

Registration

The company names, system names and product names mentioned in this document are either registered trademarks or trademarks of their respective companies. In some cases, trademark symbols such as "™" or "®" are not specified in this document.